

SKETCH PLAN OF PORTIONS OF THE SECOND FLOOR OF A BUILDING LOCATED AT 126 EAST 15TH STREET, NORTH VANCOUVER, BC.

FOR LEASE PURPOSES

SCALE 1:100



ALL DISTANCES ARE IN METRES AND DECIMALS THEREOF.

THE INTENDED PLOT SIZE OF THIS PLAN IS
280mm IN WIDTH BY 432mm IN HEIGHT (B SIZE)
WHEN PLOTTED AT A SCALE OF 1:100

ALL ANGLES ARE 45° OR 90° AND MULTIPLES THEREOF,
UNLESS OTHERWISE NOTED.

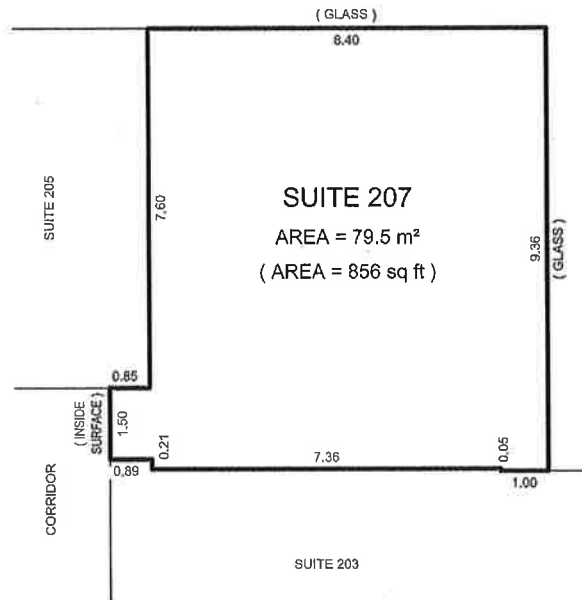

THE AREAS SHOWN WITH THE HEAVY OUTLINE HAVE BEEN COMPUTED BY MEASURING THE AREA ENCLOSED BY:
- THE INSIDE FINISHED SURFACE OF PERMANENT OUTER BUILDING WALLS, MAJOR VERTICAL PENETRATIONS, AND BUILDING COMMON AREAS (AS NOTED);
- THE INSIDE SURFACE OF THE WINDOW SYSTEM WHEN GLASS IS THE DOMINANT PORTION OF THE OUTER BUILDING WALL (AS NOTED);
- AND THE CENTRE OF PARTITIONS THAT SEPARATE THE AREA BEING MEASURED FROM ADJOINING STORE OR OFFICE AREAS (UNLESS OTHERWISE NOTED).

NO DEDUCTIONS HAVE BEEN MADE FOR COLUMNS AND PROJECTIONS NECESSARY TO THE BUILDING.

SEE BOMA STANDARD Z65.1-1996

BENNETT LAND SURVEYING LTD.
B.C. LAND SURVEYORS
#201 - 275 FELL AVENUE
NORTH VANCOUVER, B.C.
V7P 3R5
PH. 604-980-4868
FX. 604-980-5858
www.bennettsurveys.com

NOTES:

THIS PLAN HAS BEEN PREPARED FOR LEASE PURPOSES ONLY AND IS FOR THE EXCLUSIVE USE OF OUR CLIENT.

ALL RIGHTS RESERVED. NO PERSON MAY COPY, REPRODUCE, TRANSMIT OR ALTER THIS DOCUMENT IN WHOLE OR IN PART WITHOUT THE CONSENT OF BENNETT LAND SURVEYING LTD.

BENNETT LAND SURVEYING LTD. ACCEPTS NO RESPONSIBILITY OR LIABILITY FOR ANY DAMAGES THAT MAY BE SUFFERED BY A THIRD PARTY AS A RESULT OF ANY DECISIONS MADE, OR ACTIONS TAKEN BASED ON THIS DOCUMENT.

CERTIFIED CORRECT

THIS 7TH DAY OF APRIL, 2015.

MICHAEL J. SEITZ, B.C.L.S.

FIELD SURVEY COMPLETED ON APRIL 2, 2015.

THIS DOCUMENT IS NOT VALID UNLESS ORIGINALLY SIGNED AND SEALED.